



4, TEMPLAR TERRACE

RAMSEY, IM8 3DP

£325,000
FREEHOLD

This Well Presented 5 Bedroom Town House Sits In The Heart of Ramsey conveniently positioned within waking distance to all of Ramsey Towns Shops, Mooragh Park, and all of the towns Amenities and Schools. This property has been well maintained and decorated and has lovely wooden flooring throughout the very spacious ground floor living areas. This is an ideal property for a family.



- Well Presented 5 Bedroom Town House • 2 Large Living/Family Rooms • Good Sized Modern Kitchen • Master Double Bedroom With Ensuite • Further 4 Double Bedrooms • Family Bathroom and A Further Shower Room • Finished To A Lovely Standard • Two Parking Spaces To The Rear of The Property



Overview

Nestled in the heart of Ramsey, Templar Terrace on Gibson Street presents a splendid opportunity for those seeking a spacious family home. This well-presented terraced house boasts five generously sized bedrooms and three bathrooms, making it an ideal choice for families or those who appreciate ample living space.

The property is conveniently located within walking distance of all the town's shops, Mooragh Park, and essential amenities, ensuring that everything you need is just a stone's throw away. The ground floor features beautifully maintained wooden flooring that enhances the spacious living areas, creating a warm and inviting atmosphere for both relaxation and entertaining.

Additional Information

Rateable Value: For latest rateable value please contact the Rates Office on 685661

Inclusions : TBC

School District: Bunscoill Rumsaa and Ramsey Grammar School

Directions

From Parliament Square drive up Bowring Road. Turn Right down North Shore Road at the

second roundabout. Half way down North Shore Road just past the bike shop turn right into Shipyard road. Templar Terrace can be found on the left hand side approx 100 yards down and number 4 is clearly marked by our for sale board.



GROUND FLOOR
501 sq.ft. (46.6 sq.m.) approx.

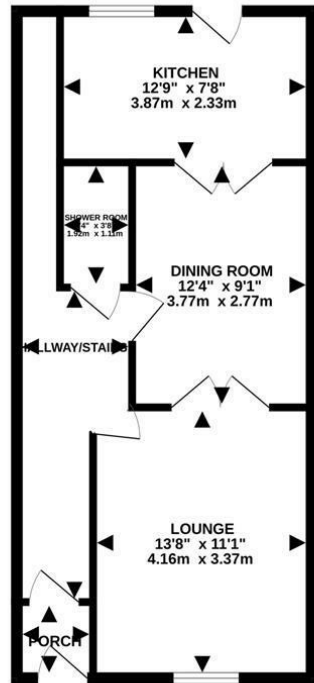

1ST FLOOR
102 sq.ft. (9.5 sq.m.) approx.

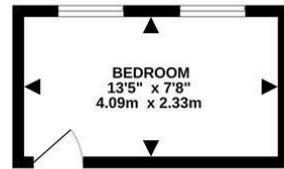

2ND FLOOR
301 sq.ft. (27.9 sq.m.) approx.

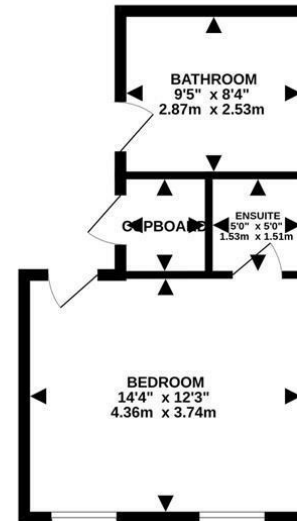

3RD FLOOR
447 sq.ft. (41.5 sq.m.) approx.

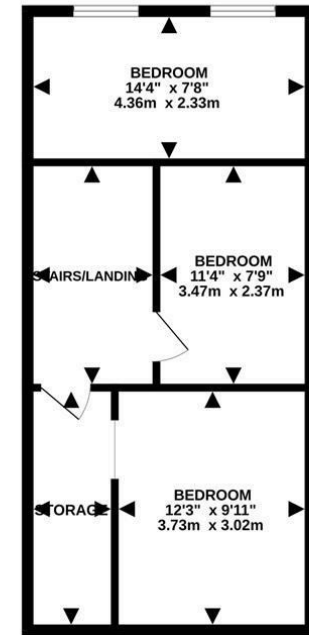

TOTAL FLOOR AREA : 1351 sq.ft. (125.5 sq.m.) approx.

Whilst every attempt has been made to ensure the accuracy of the floorplan contained here, measurements of doors, windows, rooms and any other items are approximate and no responsibility is taken for any error, omission or mis-statement. This plan is for illustrative purposes only and should be used as such by any prospective purchaser. The services, systems and appliances shown have not been tested and no guarantee as to their operability or efficiency can be given.

Made with Metropix ©2025